



# CYLINDRICAL CASED AXIAL FLOW FANS

## TRB / TREB Series



TREB

TRB

Range of cylindrical cased axial flow fans manufactured from high grade rolled sheet steel and finished with a tough black polyester paint coating and provided with a **Sickle blade impeller** fitted on an external rotor motor. Suitable for many general low pressure extract/supply ventilation applications. Available, depending upon the model, with single phase motors in 2 or 4 poles.

### Motors

All the motors are IP44 Class F insulation, equipped with **thermal protection** and **ball bearings greased for life**.

Electrical supply:

Single phase 230V-50Hz. (Capacitor located inside the wiring terminal box).

All models are speed controllable.

### Additional Information

Direction of air:

TREB Models: form (A) configuration (Motor over Impeller).

TRB Models: form (B) configuration (Impeller over Motor).



## APPLICATIONS



### Model type TRB

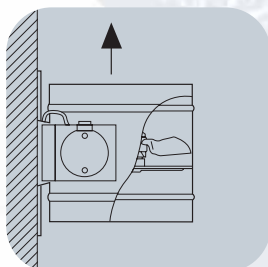

Suitable for mounting on walls, ceilings or support structures, etc. Integrated mounting bracket with fixed outlet wiring box (can be moved either right or left side of the fan bracket.)

### Model type TREB

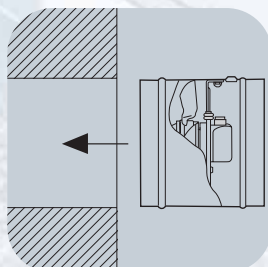

Suitable for installation within a wall or ceiling structure. Wiring terminal box fitted on the motor

### Flame retardant terminal box



Terminal box in flame retardant plastic V0 **located outside the airflow** and including the capacitor

### High efficiency "Sickle blade" impeller



**"Sickle Blade"** impeller specifically designed to ensure the highest and most **efficient airflow performance** with the **lowest noise level**. **Dynamically balanced** to ISO 1940 standard. Manufactured from pressed sheet steel

## ■ Technical characteristics

Before installation check that the product electrical characteristics listed on the data plate label (Voltage, power, frequency etc) match those of the intended electrical supply.

Model	Speed (r.p.m.)	Maximum absorbed power (W)	Maximum absorbed current (A)	Maximum air volume (m <sup>3</sup> /h)	Sound pressure level* (dB(A))	Weight (kg)
<b>MODEL TYPE – TRB</b>						
TRB/2-200	2775	60	0,34	845	54	4,6
TRB/4-200	1475	35	0,19	450	40	4,5
TRB/2-250	2685	128	0,55	1810	59	5,6
TRB/4-250	1450	40	0,21	950	43	5,1
TRB/4-300	1380	78	0,33	1690	52	6,2
TRB/4-350	1400	130	0,55	3070	52	7,3

<b>MODEL TYPE – TREB</b>						
TREB/2-200	2775	60	0,34	845	60	3,7
TREB/4-200	1475	35	0,19	450	42	3,6
TREB/2-250	2685	128	0,55	1810	65	4,7
TREB/4-250	1450	40	0,21	950	47	4,2
TREB/4-300	1380	78	0,33	1690	61	5,4
TREB/4-350	1400	130	0,55	3070	58	7,2

\*Measured at a distance of 1.5m (for model TREB this figure represents the inlet sound pressure level).

## ■ Dimensions (mm)

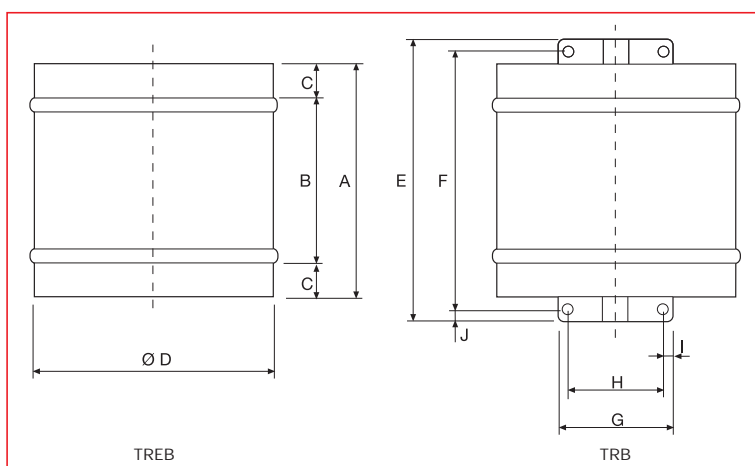

Model	A	B	C	Ø D	E	F	G	H	I	J
TRB-200	250	174	38	206	300	269	114	94	10	15,5
TRB-250	250	174	38	260,4	300	269	114	94	10	15,5
TRB-300	250	174	38	308,5	300	269	114	94	10	15,5
TRB-350	250	174	38	362,4	300	269	114	94	10	15,5
TREB-200	250	174	38	206	-	-	-	-	-	-
TREB-250	250	174	38	260,4	-	-	-	-	-	-
TREB-300	250	174	38	308,4	-	-	-	-	-	-
TREB-350	250	174	38	362,4	-	-	-	-	-	-

## Performance curves

- Q = Air volume in, m<sup>3</sup>/hr and m<sup>3</sup>/s.
- Pe = Static pressure in mmWG and Pa.
- Dry air at 20°C and 760 mmHg.
- Air flow data in accordance with the following standards: UNE 100-212-89, BS 848, Part 1; AMCA 210-85 and ASHRAE 51-1985.

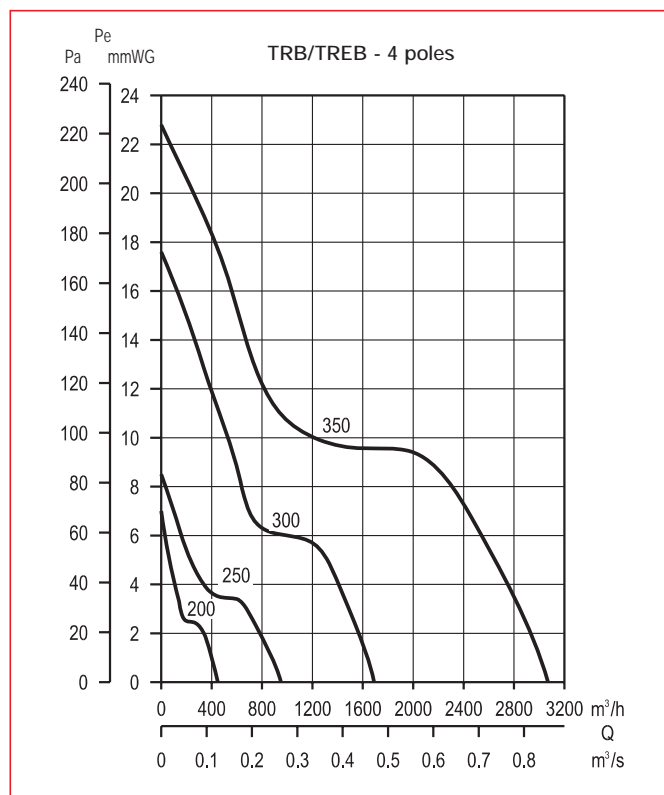
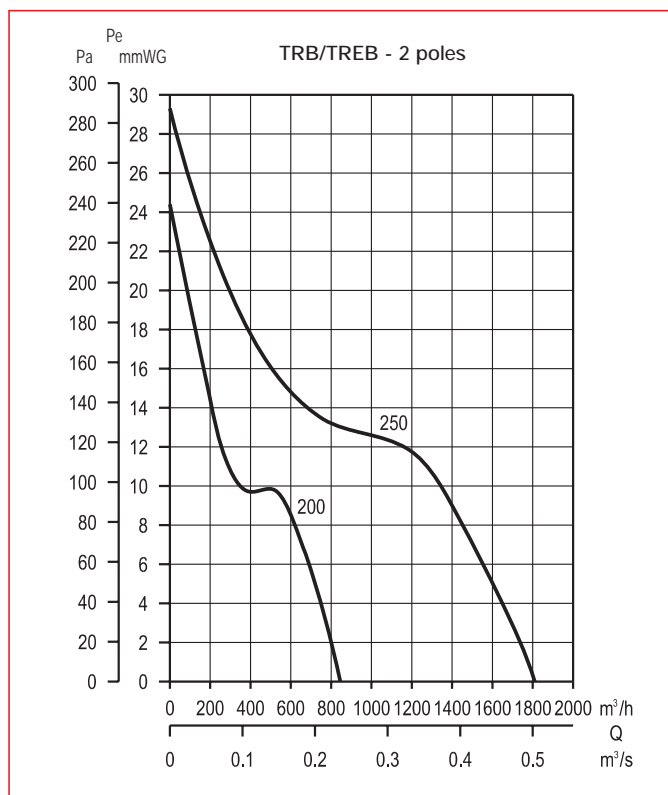

TRB / TREB

Cylindrical cased axial flow fans

## Electrical accessories



**REB-1N / REB 2,5N**  
Electronic single phase speed controllers



**RMB**  
Single phase auto- transformer speed controllers

